

LAND USE DEVELOPMENT DATA:

LAND USE DESIGNATION	LAND USE DESCRIPTION	LAND AREA (ACRES)	PERCENT	BUILDING AREA SF/GPA (1)
PRD-2	PLANNED RESIDENTIAL DISTRICT-ESTATE	125.3	7.4	N/A
PRD-4	PLANNED RESIDENTIAL DISTRICT-SINGLE FAMILY	119.0	7.0	N/A
PRD-6	PLANNED RESIDENTIAL DISTRICT-SINGLE FAMILY	54.8	3.3	N/A
PRD-10	PLANNED RESIDENTIAL DISTRICT-MULTIPLE FAMILY	60.1	3.6	N/A
PMD	PLANNED MULTI-USE DEVELOPMENT	35.8	2.1	389,862
PCD	PLANNED COMMERCIAL DISTRICT	263.2	15.8	3,033,360
PD	PLANNED INDUSTRIAL DISTRICT INCLUDING ELECTRIC SUBSTATION AND "PARK AND RIDE" SITES	234.4	19.8	4,398,839
	OPEN SPACE USE AREAS	211.8	12.8	N/A
	RIGHT-OF-WAY	164.7	9.7	N/A
	EXISTING PLATTED AREAS			
	HOMESTEAD NORTH (2.8 DU/AC)	27.2	1.6	N/A
	HOMESTEAD (3.7 DU/AC)	78.8	4.7	N/A
	THE HEIGHTS (3.1 DU/AC)	100.8	6.0	N/A
	CREEKSIDE (4.1 DU/AC)	17.1	1.0	N/A
	LARAT RANCH (3.1 DU/AC)	49.3	2.9	N/A
	CARRIAGES (2.9 DU/AC)	7.9	0.5	N/A
	SCHOOL SITE (CREEKSIDE MIDDLE & ELEMENTARY)	26.8	1.6	N/A
	JACKSON CREEK CROSSING (PCD)	14.7	0.9	160,083
	<b>TOTAL</b>	<b>1,892.0</b>	<b>100%</b>	<b>7,798,869</b>

NOTES:

- (1) TYPICAL FLOOR AREA RATIOS ARE AS FOLLOWS:
- a) OFFICE - .45
- b) RETAIL COMMERCIAL - .25
- c) INDUSTRIAL - .35
- d) MULTI-USE - .25

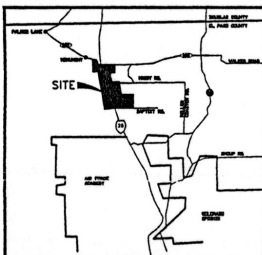
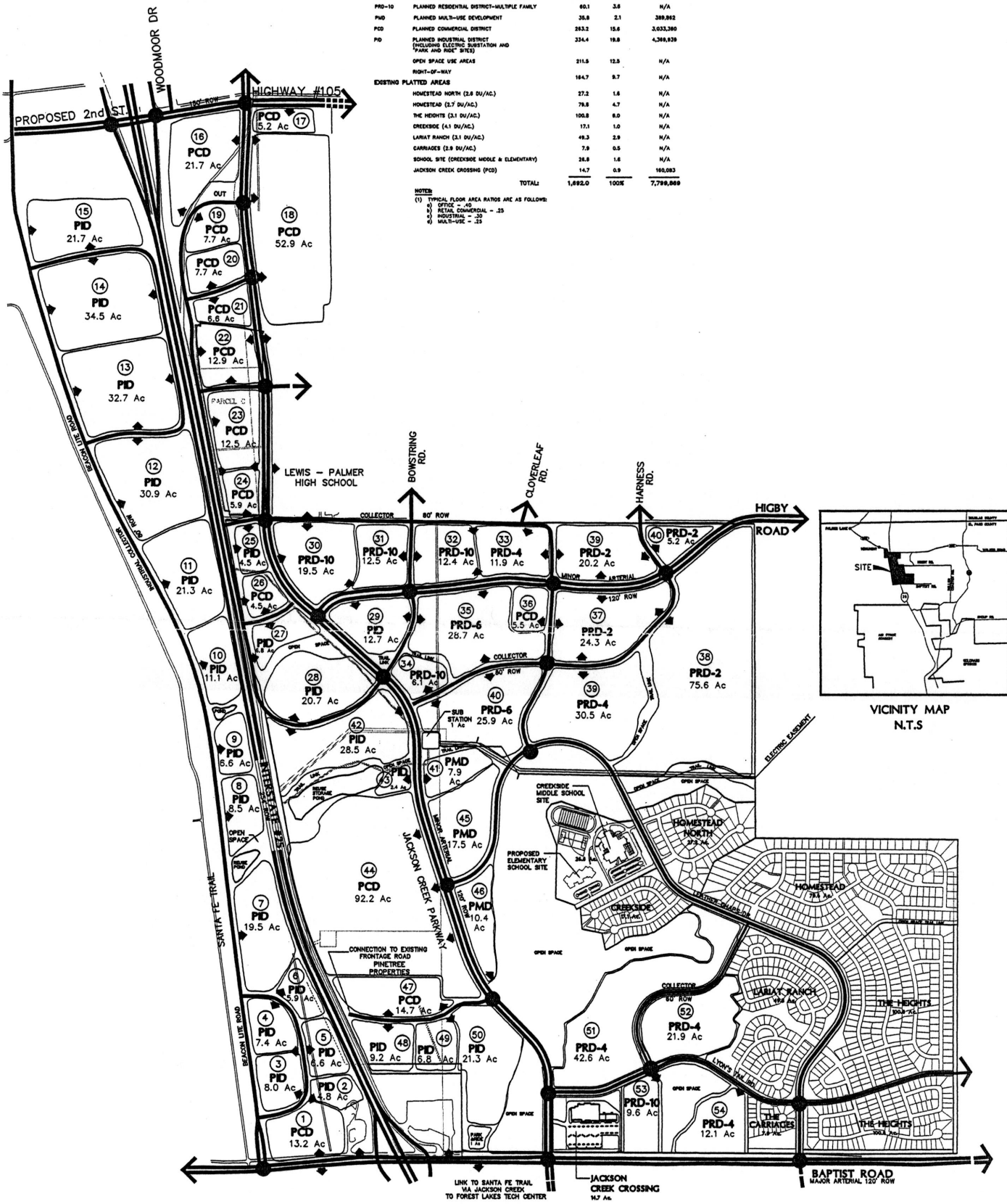

RECEIVED  
JUL 17 2003

